

Mama's Minis

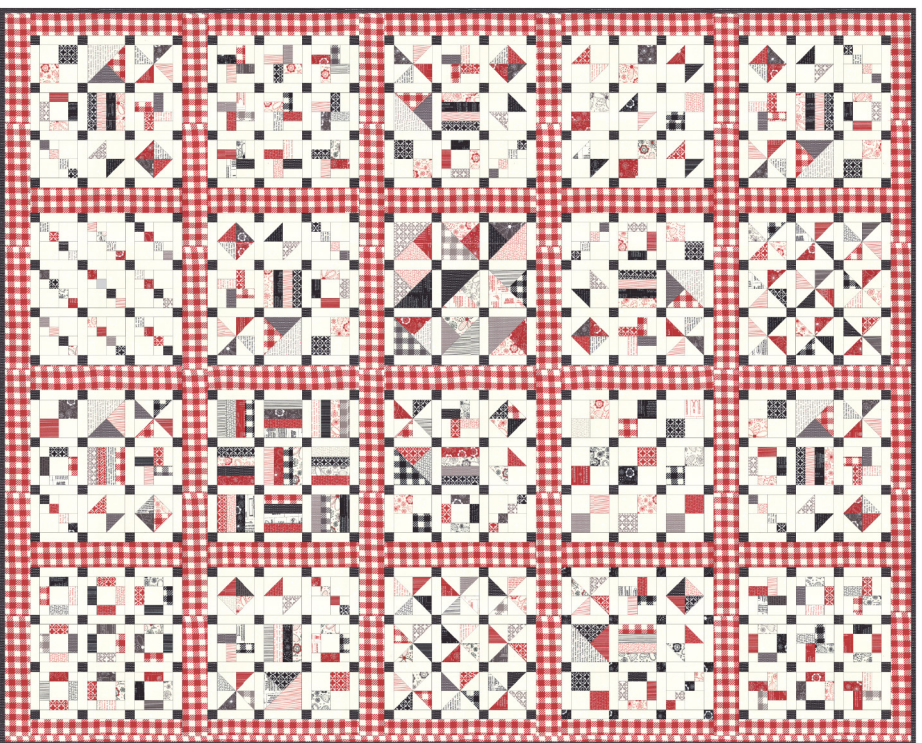

What You Need

Option 1

- Multi - -----
- Fat Eighth Bundle (40 prints 9" x 22")
- Background - 2 yd.
- Sashing - 1 2/3 yd.
- Binding & Cornerstones - 1 1/4 yd.
- Backing - 4 1/2 yd.

Option 2

- Red & Cream - -----
- 11 Red Prints - 1/2 yd. each print
- Cornerstones - 1/2 yd.
- Background & Sashing - 3 1/4 yd.
- Binding - 1/2 yd.
- Backing - 4 1/2 yd.

The fabric collection "Volume II" is designed by Sweetwater and manufactured and distributed by Moda. www.unitednotions.com

www.thesweetwaterco.com



Sweetwaters

name:

mama's minis

item:

P233

fabric collection:

Volume II

mama solid sew revisited

Finished Quilt: 58" x 72"



INSTRUCTIONS

This quilt consists of nine different mini blocks that are combined in one 12" block or the 12" blocks can be made with nine mini blocks of one design. The 12" blocks can also have two or three mini block designs or whatever combination you choose within the 12" block. The sample quilt includes a variety of 12" blocks. Some have all nine of the mini blocks, some have nine mini blocks are of one design, and others have five of one mini design and 4 of another mini design. The choice is completely yours!

Make twenty 12" finished blocks (blocks are 12 1/2" before they are set into rows), combining the mini blocks in any way you choose. Before cutting, make sure to read all of the instructions. For best results we suggest you press all seams open. 1/4" seam allowance is included. You can make each 12" block one at a time, or make all the mini blocks first, and then arrange them in the twenty 12" blocks.

Mini Block Designs - Diagrams 1 through 9

Each diagram gives cutting dimensions for each mini block. Diagrams also show the placement of each piece in the mini block. When finished, you will have 180 mini blocks. Nine mini blocks go into each 12" block. There are twenty 12" blocks.

For Half Square Triangles In Blocks 1, 2 and 7

1. Cut squares the dimension given on each triangle.
2. With right sides together, place two squares together.
3. Mark a diagonal line with a pencil from one corner to the opposite corner.
4. Sew on the marked line.
5. Trim away one corner 1/4" from the sewn line.
6. Press the triangle back.
7. Refer to half square triangle diagram #10

Sashing and Cornerstones

Sew mini blocks together with sashing and cornerstones to make 12" blocks.

1. For each 12" block, cut 24 sashing pieces 1 1/4" x 3 1/2" to be sewn between mini blocks.
2. Cut 16 cornerstones 1 1/4" x 1 1/4".
3. Refer to diagram #11 for placement of block sashing and cornerstones.

Rows

There are four blocks in each row with five rows total.

2 1/2" wide sashing strips are sewn between the 12" blocks. Refer to digital diagram of quilt for placement of blocks and sashing between blocks.

Backing and Batting

With wrong sides together, layer the back, batting and quilt top. Quilt as desired. Trim away excess backing and batting.

Binding

1. Cut eight strips 2 1/4" x the width of the fabric.
2. With wrong sides together, sew strips end to end to make one long strip.
3. Fold in half lengthwise and press.
4. Sew to the top of the quilt matching the raw edges and mitering the corners. Refer to the mitering diagram for mitering.
5. Turn the folded edge to the back and hand stitch in place.

Mitering Diagram

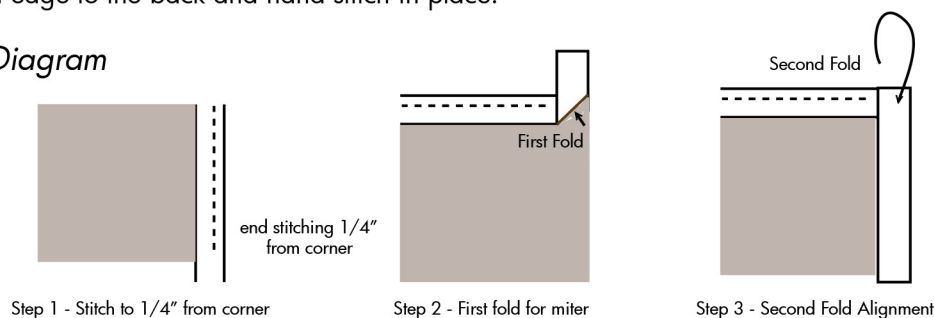



Block 1

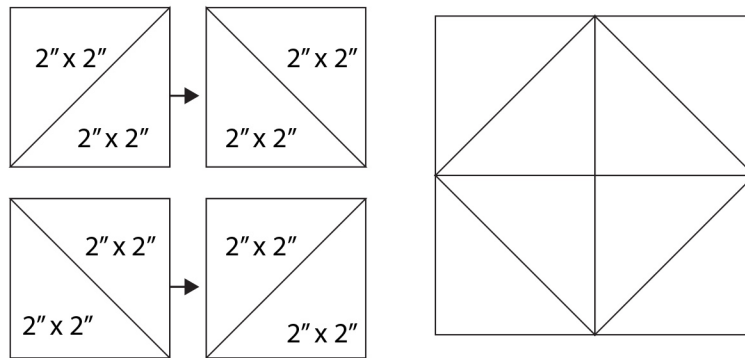

Block 2

Make 2 half square triangle sections

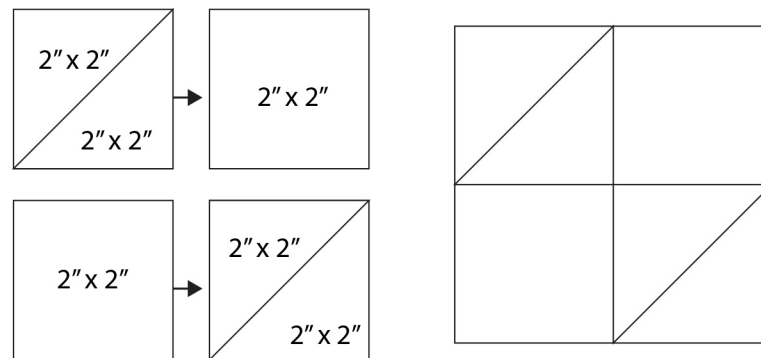

Block 3

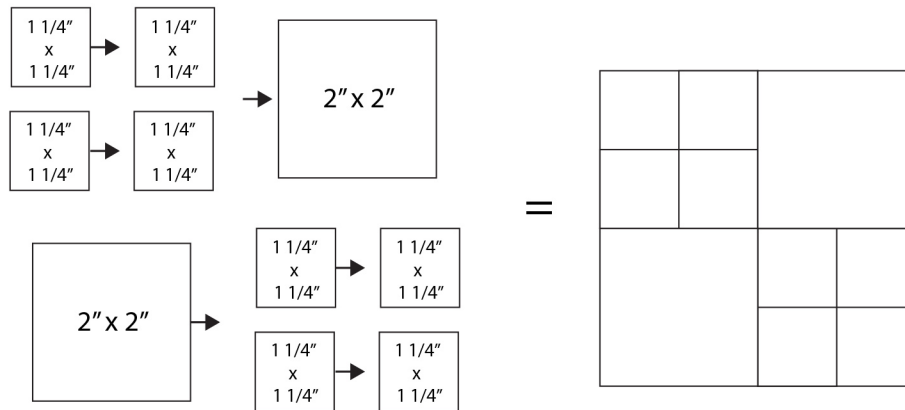

Block 4

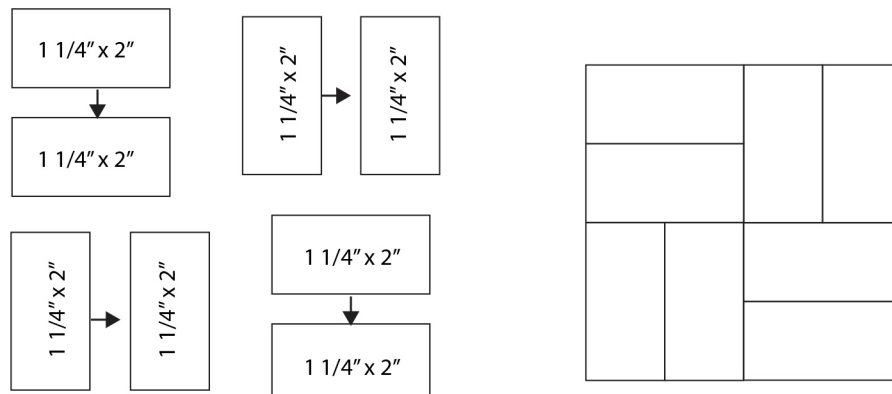



Block 5

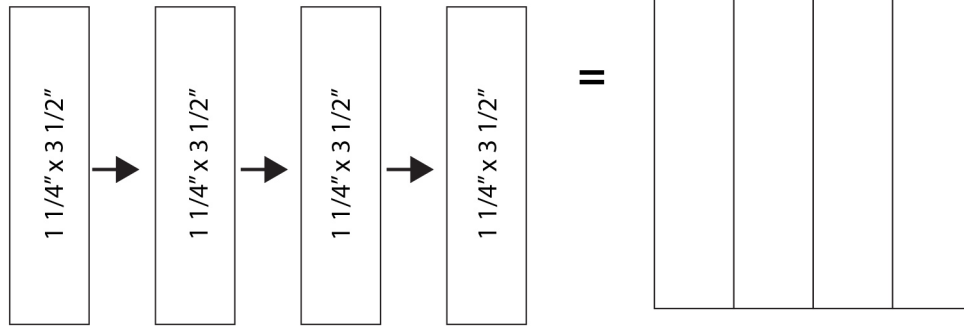

Block 6

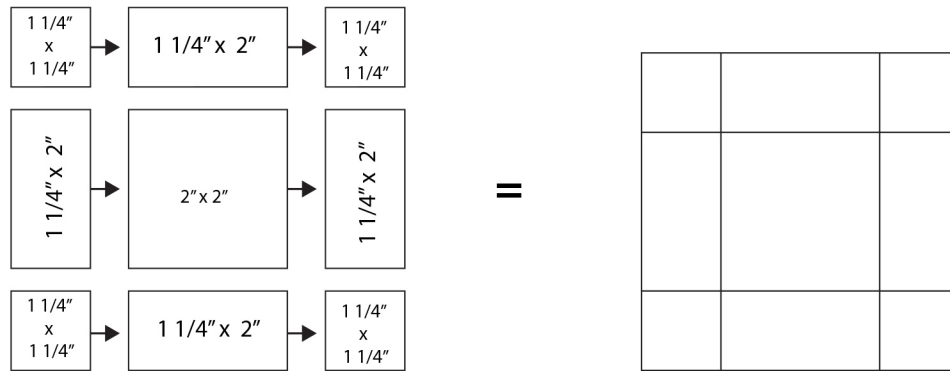

Block 7

Make 4 half square triangle sections

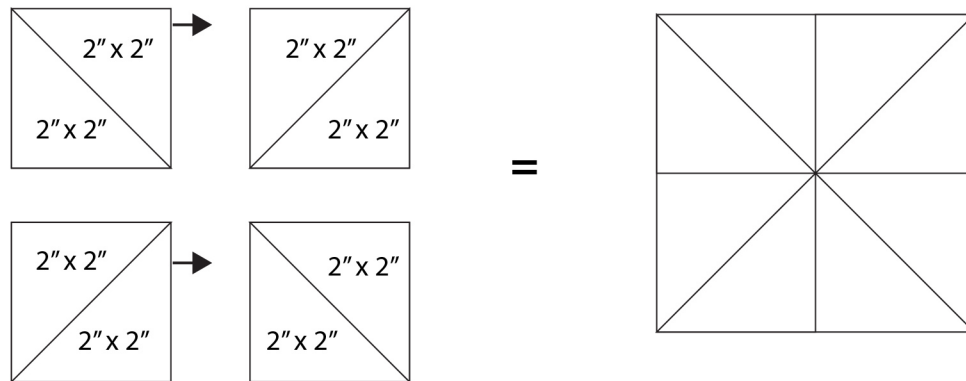

Block 8

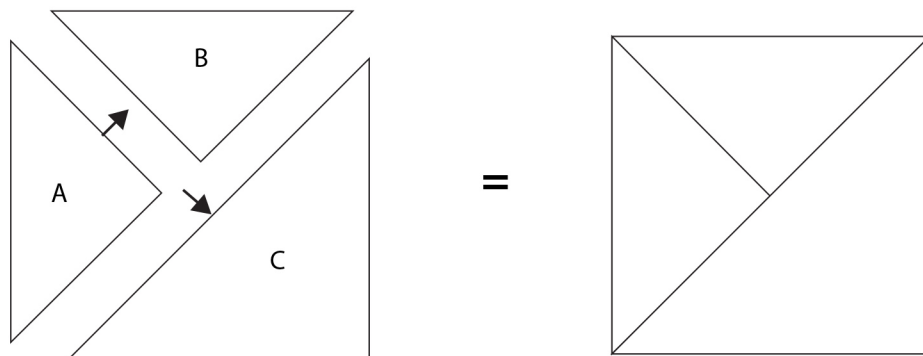

A- Cut 1 square 3" x 3", cut in half diagonally, use 1 triangle
 B- Cut 1 square, 3" x 3", cut in half diagonally, use 1 triangle
 C- Cut 1 square 3 7/8" x 3 7/8", cut in half diagonally, use 1 triangle



Quilt Diagram

