

# Sweetwater

## house pincushion

4" x 3 1/2" x 3 1/2"

### what you need.....

**House:** 1/6 yard

**Roof:** 1/6 yard

**Doors & Windows:** 5"x5" scrap solid fabric

**Fusible Web:** 5"x5" scrap

**Cotton Batting:** 6"x6"

**Buttons:** two 3/8"

**Heavy thread to stitch around doors and windows**

**Filling:** Crushed walnut shells or polyester stuffing (crushed walnut shells can be found at pet supply stores and will give the pincushion some weight)

**Hot Glue Gun**



## Instructions

1/4" seam allowance is included

### House

1. Cut the following from the 1/6 yard for the house. Refer to Diagram #1.
2. Cut two house shapes from the pattern.
3. Cut one piece 4" x 14 1/2"

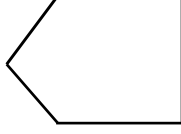

Cut 2

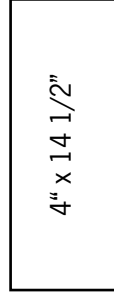

Cut 1

Diagram #1

### House Construction

1. Fold under 1/4" on each 4" side of the 4" x 14 1/2" strip and press.
2. Mark dots on the wrong side of the two house shapes as indicated on the pattern. Refer to Diagram #2.

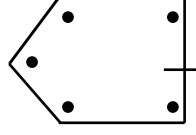

Diagram #2

start sewing here

3. With right sides together sew the long strip to the house shape with the house on top.
4. Start sewing at the bottom of the house shape matching the turned under 4" side to the center bottom dot. Refer to Diagram #3

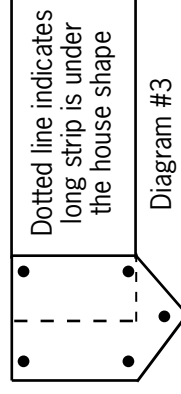

Diagram #3

5. Continue sewing around the house shape pivoting at each dot.

**Instructions Continued on Back**

Fabric kits for the house pincushion are available on our etsy site -

[www.sweetwaterscrapbook.com](http://www.sweetwaterscrapbook.com)

© 2011 Sweetwater

[www.sweetwaterscrapbook.com](http://www.sweetwaterscrapbook.com)

[www.sweetwaterscrapbook.com](http://www.sweetwaterscrapbook.com)

[www.sweetwaterstreet.com](http://www.sweetwaterstreet.com)

[blog: www.sweetwater.typepad.com](http://blog.www.sweetwater.typepad.com)

[info@sweetwaterscrapbook.com](mailto:info@sweetwaterscrapbook.com)

little sprout  
c o l l e c t i o n

## Instructions Continued

- How to pivot: When you come to a dot stop and position your needle in the dot, lift the presser foot with the needle still down. The edge of the top layer will need to line up with the edge of the bottom layer so you will turn only the top layer to pivot. When you reach the first folded edge where you started, the other folded edge of the long strip will layer over the first folded edge.
- Repeat the above steps for the other house piece.
- Fill the house with crushed walnut shells or polyester stuffing at the bottom opening.
- Sew the opening closed with a slipstitch

### Doors & Windows

- Iron a 5" x 5" piece of fusible web to the wrong side of a 5" x 5" piece of fabric.
- Doors - with a rotary cutter, cut two pieces from the fused square into 2 1/4" x 1 1/4".
- Windows - Cut two pieces 1 1/4" x 1 1/4".
- Peel off the paper backing on all pieces and iron the doors to the sides of the house on the peaked side. Iron the windows to the other sides.
- By hand, sew heavy thread around each window and door close to the edge using a short running stitch. Also sew across the center of each window. Refer to Diagram #4.
- Sew a button to each door to indicate a door knob.
- Option: You can substitute an iron on hometown label for one of the doors.

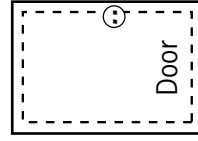
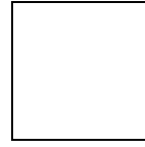

Diagram #4

### Roof

- Cut two pieces 5 3/4" x 5 3/4".
- Cut a slit in one piece. Refer to Diagram #5



cut two 5 3/4" x 5 3/4"  
cut slit in one piece  
Diagram #5

- With right sides together, layer the two pieces over cotton batting that is slightly larger.
- Make sure the piece with the slit is on top.
- Sew around all the edges. Refer to Diagram #6.

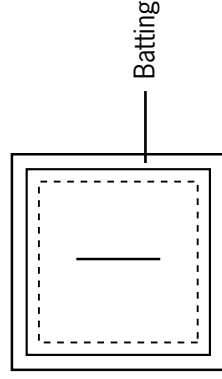

Diagram #6

- Trim excess batting away and trim corners.
  - Turn right side out through the slit and press.
  - Machine topstitch 1/4" from the edges.
  - Fold in half and press with the slit on the underside. The crease will be placed along the top peak of the house.
  - Apply hot glue along the peak seam line of the house and place the roof over. You will need more hot glue along the sides of the house where the roof touches.
  - Apply by lifting up the roof edges and apply just where needed. Refer to Diagram #7.
- TIP: Do not apply glue on the roof portion where pins will be inserted as they will not stick through the glue.

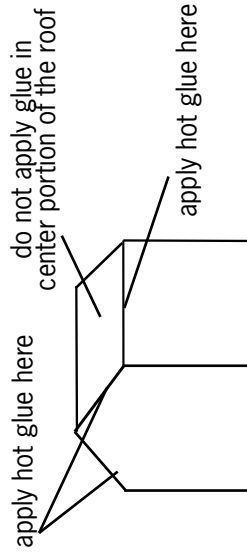

Diagram #7

